

152 Burrs to be removed.
去除毛刺
689 Sharp edges to be removed.
锐边去除
164 All over, except where otherwise stated.
其余

Surfaces, drilled holes: ∇ Ra6.3 (✓)
Surfaces, other: ∇ Ra3.2 (✓)

689 锐边去除
Sharp edges to be removed.
054 Smooth.
光滑
Inlet edge must be chamfered and rounded as shown.
进气口边缘必须倒角, 倒圆, 如图所示

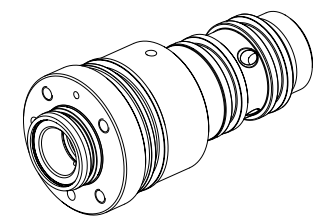

Material / Blank: SNitr
Final User Material: 38CrMoAlA
3.31

